

# The New Battery Backup Light Bulbs

UL, DOE & CEC Approved!! Read complete instructions before use

## New features

- Sleek design to fit in any lamp or fixture
- Charge indicator Light Function
- Battery Backup Mode Dimmable Option for Longer Battery Life when the power is out
- Breathable Air Holes, allows air flow to the bulb battery

## Instructions for everyday use and charging

1. Screw your bulb into a single source socket, lamp or fixture.  
**Do Not use in a multi socket lamp/fixture (If more than one bulb can be placed in the fixture or lamp, or if the switch turns on more than one light at the same time those are considered multi socket)**
2. Turn the lamp or light fixture ON, then turn it back OFF and back ON again to engage the charge mode.
3. A low glow red light will appear in the bulb indicating it is charging.
4. Leave the lamp or light fixture ON to charge.
5. A low glow green light will appear in the bulb indicating it is fully charged.
6. It is okay to keep it in charge mode all the time to ensure it is always charged when the power goes out.
7. It is also okay to charge the bulb and remove it for later use, just make sure to charge it once every few months to ensure it is fully charged when you need it.
8. When the power goes out and you would like to use your battery backup light bulb, the lamp or fixture will need to be plugged in and turned on, or the light switch on the wall needs to be turned on, if not already, for the bulb to work during the power outage.
9. The charged bulb will also work by using the provided screw on cap for light on the go.
10. The fully charged bulb will last approximately 2.5 - 8 hours, depending on whether you are using bright or dim mode.
11. The bulb can also charge with everyday use when turned on and bulb is illuminated.

## How to test your bulbs to know that it will work in a real power outage

1. Fully charge the bulb using the instructions provided above.
2. Screw the provided power cap onto the bottom of the bulb.
3. Push the black button at the bottom of the cap if the charged bulb illuminates, that tells you the bulb is working fine, and it will work in the event of a power outage.
4. Putting the bulb in a lamp and unplugging the lamp will NOT simulate a power outage and the bulb will not come on with this method. The bulb has a smart chip that determines if it is a power outage or if it is unplugged.

## To use the Battery Backup Mode Dimmable option

1. Using your already charged Living Glow bulb.
2. Screw the provided power cap onto the bottom of the bulb.
3. Push the black button at the bottom of the cap for the light to illuminate in the bright mode.
4. Push the black button at the bottom of the cap for the light to turn off.
5. Push the black button at the bottom of the cap for the light to illuminate in the dim mode.
6. Dim mode will allow the bulb battery to last longer during a power outage.
7. To get the bulb back into the bright mode simply push the black button at the bottom of the cap again to turn the light off and then push it again to turn it back on in the bright mode.
8. The fully charged bulb will last approximately 2.5 - 8 hours depending on whether you are using bright or dim mode.

### Two color options Warm Light and Daylight

**Power Cap:** The power caps are a provided device that allows the LED rechargeable bulb to become portable, use it as a flashlight to carry in your hand or hang it anywhere with the attached hook. The power cap also allows you to use the bulb on bright mode or dim mode lighting. The power cap DOES NOT charge the bulb. You must charge the bulb in the lamp or light fixture per provided charging instructions. This device will only work with LED rechargeable Bulbs.



## How to use the provided power caps

1. Using your already charged bulb.



2. Screw the provided power cap onto the bottom of the bulb.

3. Push the black button at the bottom of the cap for the light to illuminate in the bright mode.



4. Push the black button at the bottom of the cap for the light to turn off.



5. Push the black button at the bottom of the cap for the light to illuminate in the dim mode.

6. Dim mode will allow the bulb battery to last longer during a power outage.



7. To get the bulb back into the bright mode simply push the black button at the bottom of the cap again to turn the light off and then push it again to turn it back on in the bright mode.

8. The fully charged bulb will last approximately 2.5 - 8 hours depending on whether you are using bright or dim mode.



**Power Plug Adapter:** The power plugs are a provided device that allows the single socket lamp to become portable so you can move the lamp from one room to another. The power plug adapter DOES NOT charge the bulb. You must charge the bulb in the lamp or light fixture per provided charging instructions. This device will only work with LED rechargeable Bulbs.

## How to use the provided power plug adapter

1. Using your already charged bulb.
2. Screw the bulb into a single source socket lamp (a lamp with only 1 socket to screw in 1 bulb).

3. Remove the power cord from the wall outlet.

4. Plug the outlet into the provided power plug adapter.

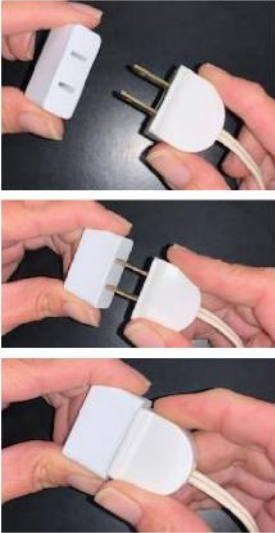

5. Turn the lamp on, and the bulb will illuminate until the bulb needs re-charged.



6. Use this device to make your once stationary lamp portable.

## How to know if your bulb is Charging

1. Turn the lamp or light fixture ON, then turn it back OFF and back ON again to engage the charge mode.

2. A low glow red light will appear in the bulb indicating it is charging.

3. Leave the lamp or fixture ON to charge.

4. A low glow green light will appear in the bulb indicating it is fully charged.

5. It is okay to keep it in charge mode all the time to ensure it is always charged when the power goes out  
6. The fully charged bulb will last approximately 2.5 - 8 hours depending on whether you are using bright or dim mode.

7. The bulb can also charge with everyday use when turned on and bulb is illuminated.



## Important Information

**DO NOT** use this bulb in a lamp or light fixture that has multiple sockets that operates/turns on more than one bulb by using the same light switch to turn the bulbs on. This causes the bulbs confusion, and they will not work properly.

If used in a 3-way or dimmer switch type lamp the switch must be set on the last/highest setting of power for it to work properly.

Remember to charge your bulb after each use to make sure it is ready for the next time you need it or charge it with everyday use.

The Battery Backup Light Bulb has a smart chip, the smart chip detects a power outage as soon as it occurs and activates the bulb's battery to provide approximately 2.5 - 8 hours of emergency light depending on whether you are using bright or dim mode.

The Smart chip protects the bulb's battery and prevents it from overheating or overcharging.

The Smart chip can also tell the difference between a power outage, and when you turn your light switch off or unplug your light fixture. This allows you to use the bulb just like a standard bulb, even during a power outage.

Made in China

# Important Information Continued

**This device complies with Part 15 of FCC Rules. Operation is subject to the following two conditions:**

- (1) This device may not cause harmful interference, and (2) This device must accept any interference received, including interference that may cause undesired operation. This equipment has been tested and found to comply with the limits for a Class B digital device, pursuant to part 15 of FCC Rules. These limits are designed to provide reasonable protection against harmful interference in a residential installation. This equipment generates, uses, and can radiate radio frequency energy and, if not installed and used in accordance with the instructions, may cause harmful interference to radio communications. However, there is no guarantee that interference will not occur in a particular installation. If this equipment does cause harmful interference to radio or television reception, which can be determined by turning the equipment off and on, the user is encouraged to try to correct the interference by one or more of the following measures:

- Reorient or relocate the receiving antenna.
- Increase the separation between the equipment and receiver.
- Connect the equipment into an outlet on a circuit different from that to which the receiver is connected.

## Warranty

1 Year warranty with proof of purchase, you may be asked to return any defective bulbs for inspection before a replacement is sent.

**"We keep it BRIGHT, even in the DARK!"**

**WARM LIGHT**

Lighting Facts Per Bulb	
Brightness:	800 lumen
Estimated Yearly Energy Cost \$1.14 Based on 3 hrs/day, HC/kWh	Cost depends on rates and use
Life	Based on 3 hrs/day 45 years Light Appearance
Appearance	Warm _____ Cool _____
	△ 3000 K
Energy Used	9.5 watts

**DAYLIGHT**

Lighting Facts Per Bulb	
Brightness:	800 lumen
Estimated Yearly Energy Cost \$1.14 Based on 3 hrs/day, HC/kWh	cost depends on rates and use
Life	Based on 3 hrs/day 45 years Light Appearance
Appearance	Warm _____ Cool _____
	A 5000 K
Energy Used	9.5 watts

MODEL

**CP-BL02-9WE**